



## MM3225 SERIES ~ Wire Wound Chip Common Mode Choke



### FEATURES

1. Miniature surface mount component – 3.2 × 2.5 mm footprint, 2.2 mm high
2. Application for CAN-BUS, Fax, ISDN, FlexRay system , Ethernet System .
3. RoHS-compliant, halogen free. 260°C compatible.

### PART NUMBERING SYSTEM

<b>MM</b>	<b>3 2 2 5</b>	—	<b>6 0 1</b>	—	<b>LF</b>
TYPE	DIMENSIONS		INDUCTANCE		LEAD FREE

### SHAPES AND DIMENSIONS

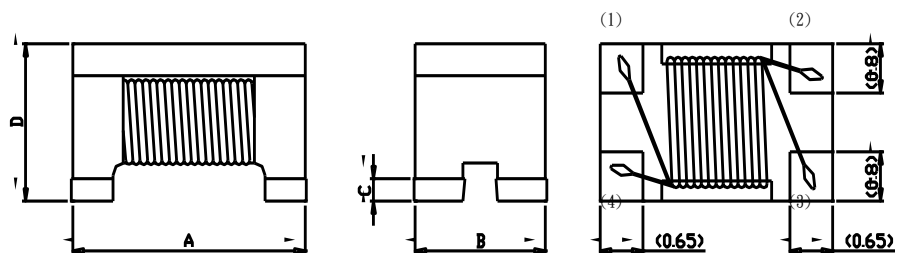

$A=3.2\pm0.2$   $B=2.5\pm0.2$   $C=0.2\pm0.1$   $D=2.2\pm0.2$

### SPECIFICATION TABLE

PART NUMBER	Common Mode Impedance( $\Omega$ ) (at 100MHz)	RATED CURRENT (mA)	DCR ( $\Omega$ ) (Max)	RATED VOLTAGE (Vdc)	INSULATION RESISTANCE (M $\Omega$ )
MM3225-800-LF	80 $\pm$ 25%	2,000	0.15	50	10 min.
MM3225-601-LF	600 $\pm$ 25%	1,000	0.25	50	10 min.
MM3225-102-LF	1,000 $\pm$ 25%	1,200	0.35	50	10 min.

Operating Temperature Range : -40°C to 105°C



# MM3225 SERIES ~ Wire Wound Chip Common Mode Choke



## PACKAGING SPECIFICATION

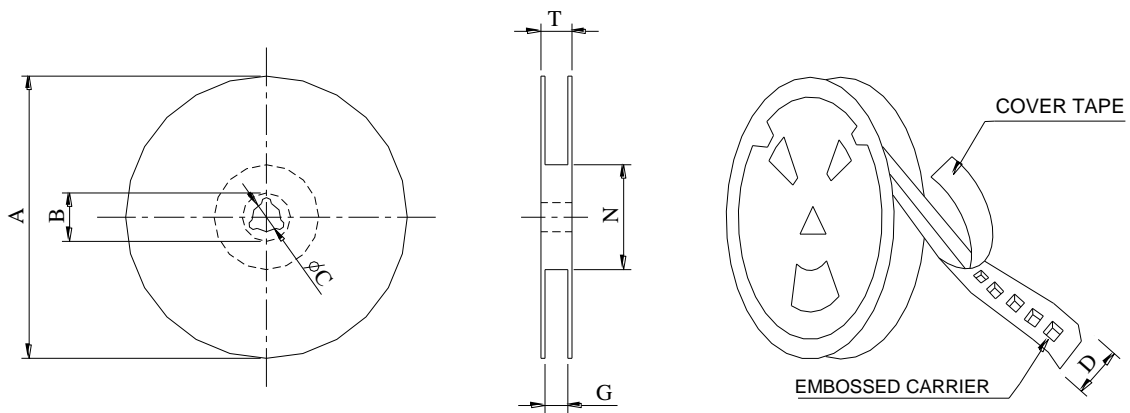

\*CARRIER TAPE WIDTH : D

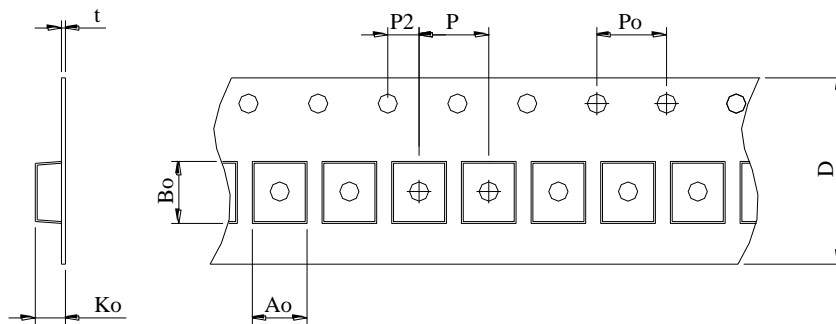

SERIES	STAYLE	Q'TY (PCS)	DIMENSIONS (m/m)								
			A	Ao	Bo	Ko	t	N	P	Po	D
MM3225	178	1,000	178	2.8	3.60	2.20	0.24	60	4	4	8.0